

Retail Leasing Opportunity in Downtown Newark, NJ

Commerce Court • 1136 Raymond Blvd • Newark, NJ 07102



RETAIL SPACE AVAILABLE

Property Highlights

- Prime Retail Space Available for Lease – 1,723 SF up to 9,000 SF (with loading dock)
- High traffic, Downtown Corner with Highly Visibility at Raymond Blvd, Commerce Street, and Entire Westerly Block Front of Mulberry Street
- 24/7 Office, Retail, Hotel and Residential Community
- Large Space is Currently Set Up as a Restaurant with Dining Area, Kitchen, Newly renovated bathrooms, Storage and Loading Dock
- Covered Parking Available in Building

Demographics	1 Mile Radius	3 Mile Radius	5 Mile Radius
Avg. Household Income	\$41,489	\$34,604	\$36,225
Households	1,177	11,745	38,615
Population	5,166	16,607	29,022



For Further Information, Please Contact:

Elliot Zeitune/ (212) 244-7410

elliott@aetnarealty.com

www.aetnarealty.com

Commerce Court Retail Center
Raymond Blvd & Commerce Court
Newark, New Jersey 07102

RETAIL SPACE AVAILABLE

Site Plan & Aerial View

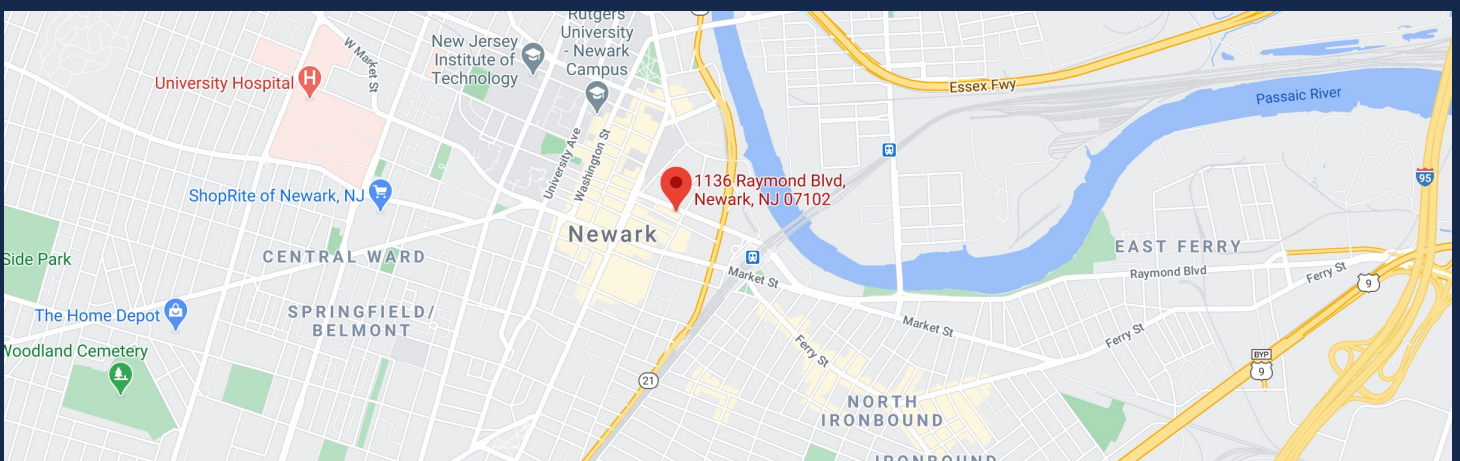
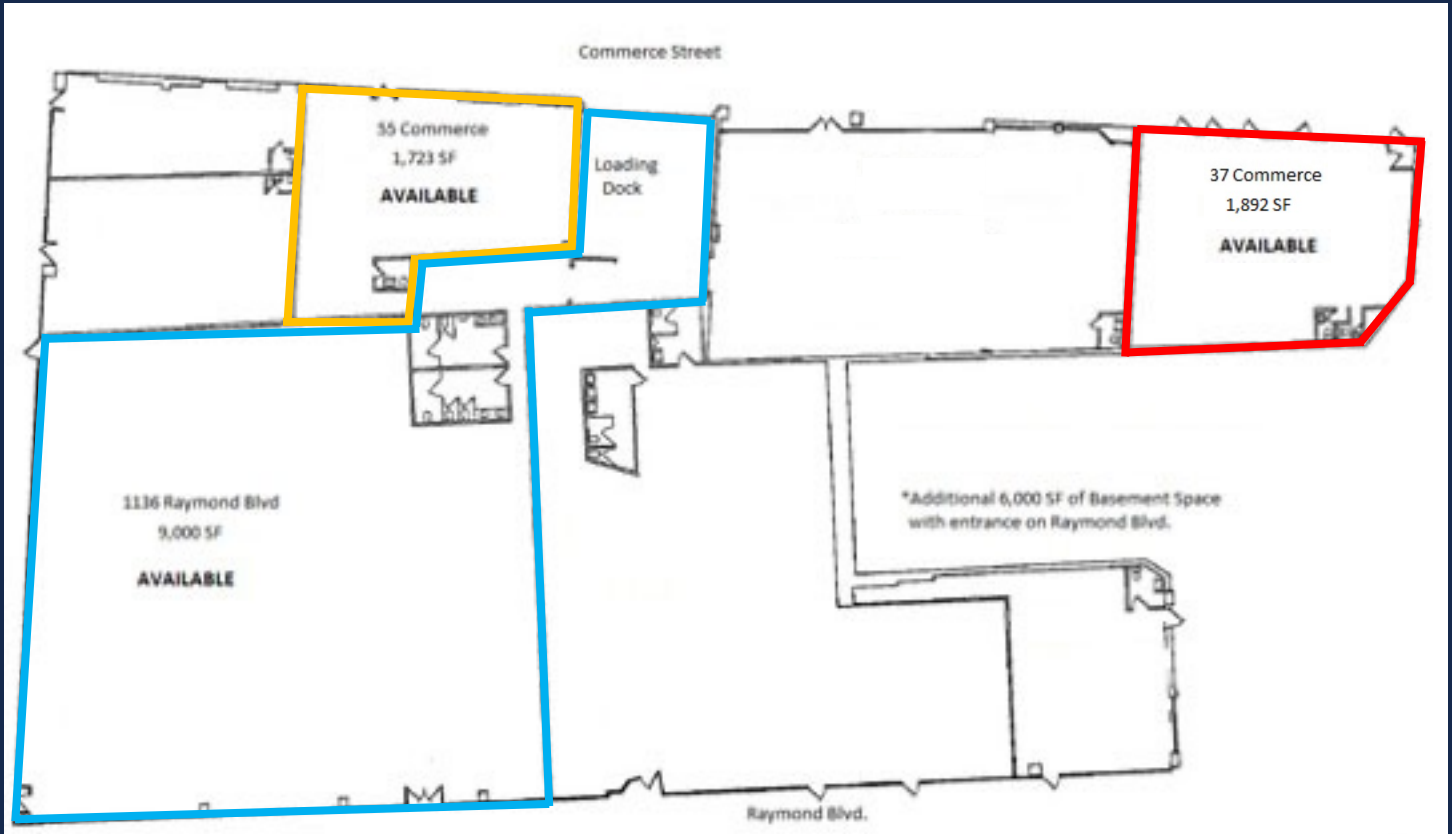

For Further Information, Please Contact:
Elliot Zeitune/ (212) 244-7410

elliott@aetnarealty.com

www.aetnarealty.com

Commerce Court Retail Center
Raymond Blvd & Commerce Court
Newark, New Jersey 07102

RETAIL SPACE AVAILABLE

Property Highlights

- Close proximity to NJPAC, Prudential Center, and Penn Station (PATH, Amtrak, NJ Transit)
- Prime Corner Space – Raymond Blvd. & Mulberry St
- Across from PSE&G Headquarters – 1 million SF office and Gateway Complex – 3 million SF office and 15,000 people daily
- Prime Corner space with sprawling frontage on Raymond Blvd. & Mulberry St.
- Walking Distance from Newark Penn Station
- Steps away from Seton Hall University – School of Law
- Minutes from Rutgers University Campus



For Further Information, Please Contact:
Elliot Zeitune/ (212) 244-7410

elliott@aetnarealty.com

www.aetnarealty.com